

STAY ON THE GROUND

LET YOUR MIND RISE

Pattern

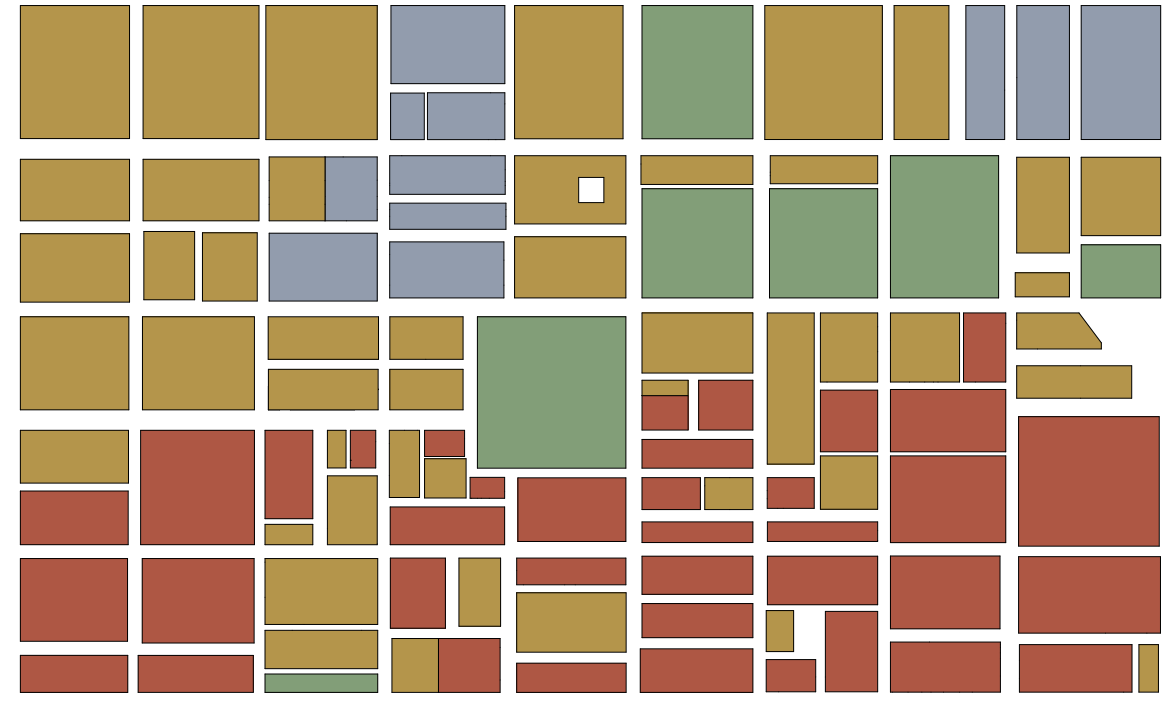

Green surfaces in 2050

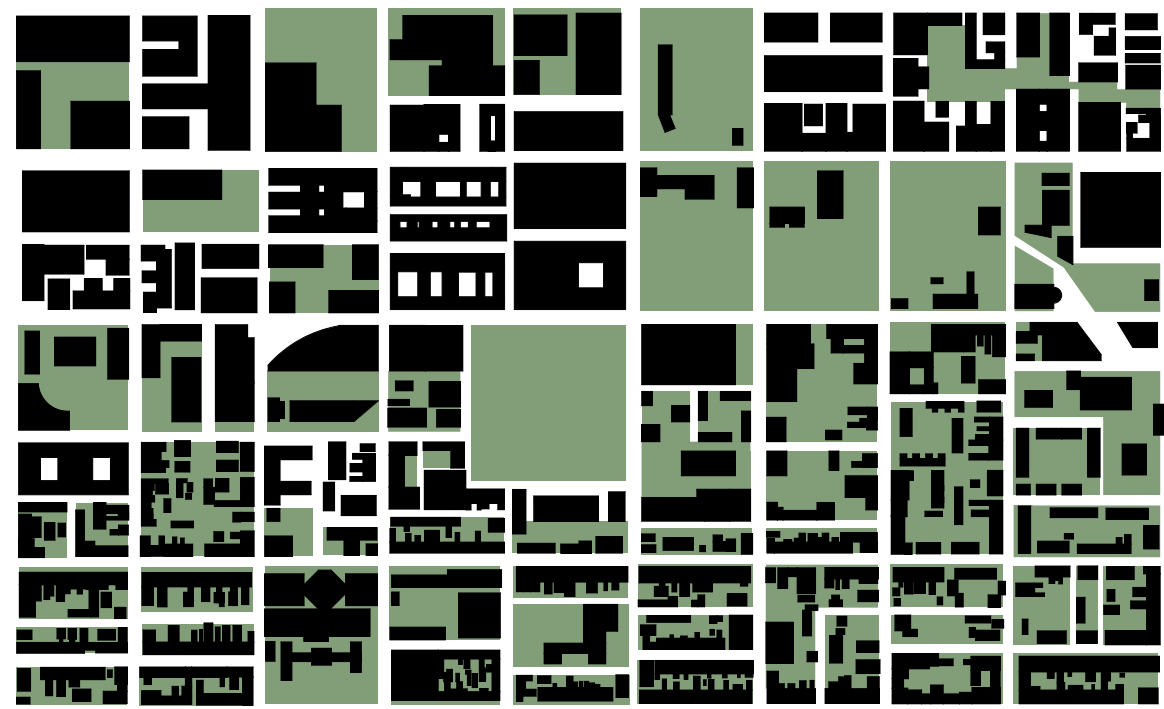

Action plan

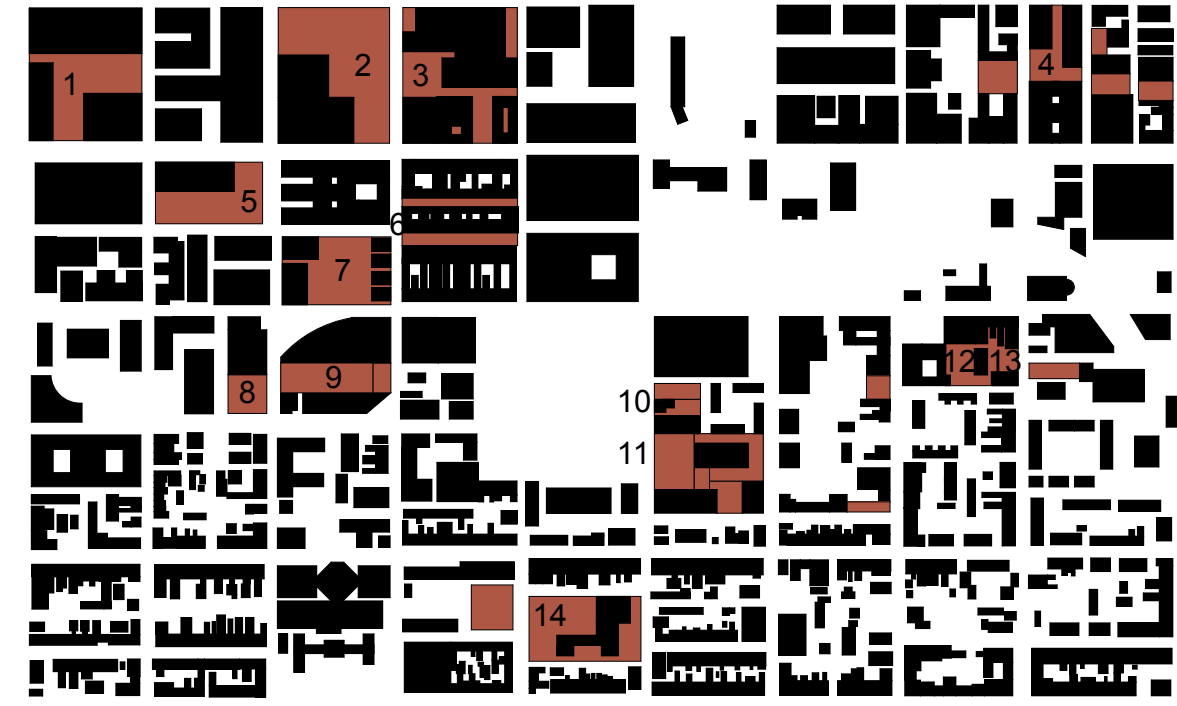

- 1 Parking lot reshape
- 2 Public space rehabilitation
- 3 New public spaces, new buildings
- 4 Block rehabilitation
- 5 Public space rehabilitation
- 6 Block rehabilitation
- 7 New public spaces, new buildings
- 8 Parking lot reshape
- 9 Small park through the block
- 10 New buildings and outdoor spaces
- 11 New park and public square
- 12 Parking lot reshape
- 13 Building site
- 14 School courtyard rehabilitation

Green surfaces

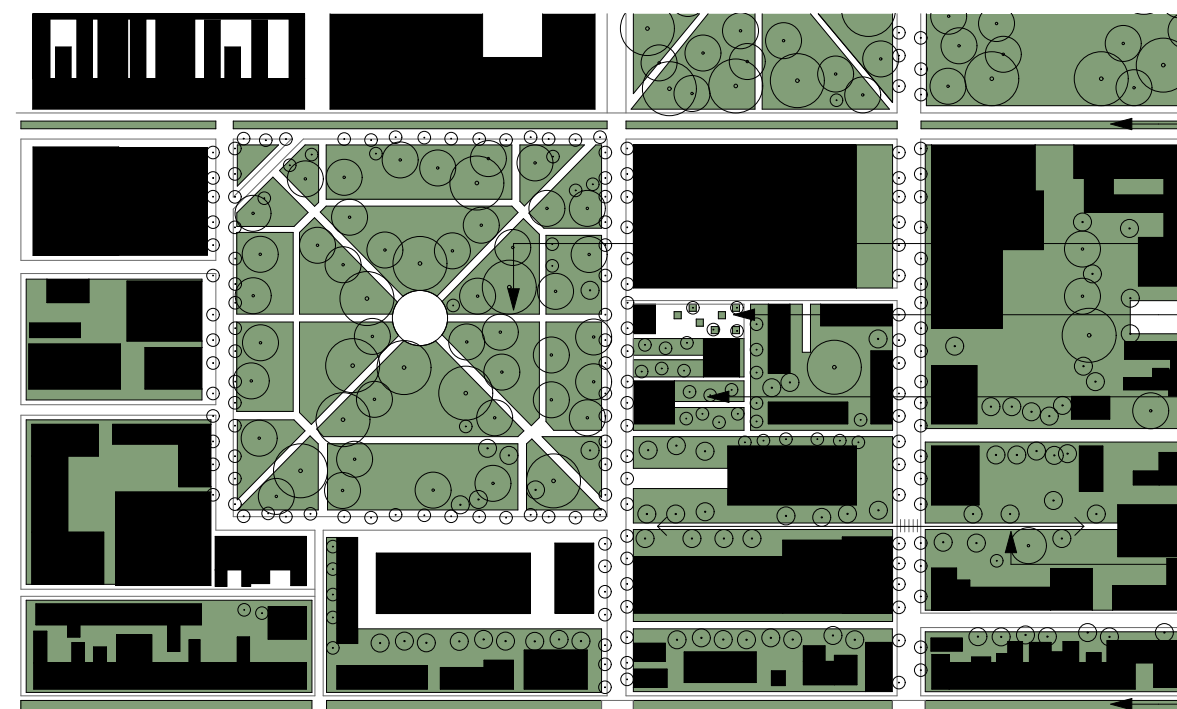

- green tramline
- new path through Washington Park
- new public square
- new buildings in park areas
- connecting green surfaces and public functions
- green tramline

Project assumption

Libraries of the future would have to fulfill variable needs of locals, offering indoor and outdoor spaces to education, recreation and community projects.

These institutions would connect everyday life activities as a place between home and work, especially in the case of Athenaeum which is situated on the border of residential and business areas.

The architectural library of Athenaeum as an emphasized building "a pride and ornament" of the built environment would have to function smartly and sustainably focusing on variable spaces supplemented by new storage and operation methods.

Project description

I aimed to reinterpret library function a new conceptual approach by repositioning the three main elements of the proposal.

The library storage is bursting skyward - symbolizing the value of knowledge - managed by automated movement system controlled by visitor's requests.

The vital public square on the ground floor functions as an outdoor library space and connects neighboring residential areas to the Washington Square Park.

Masterplan

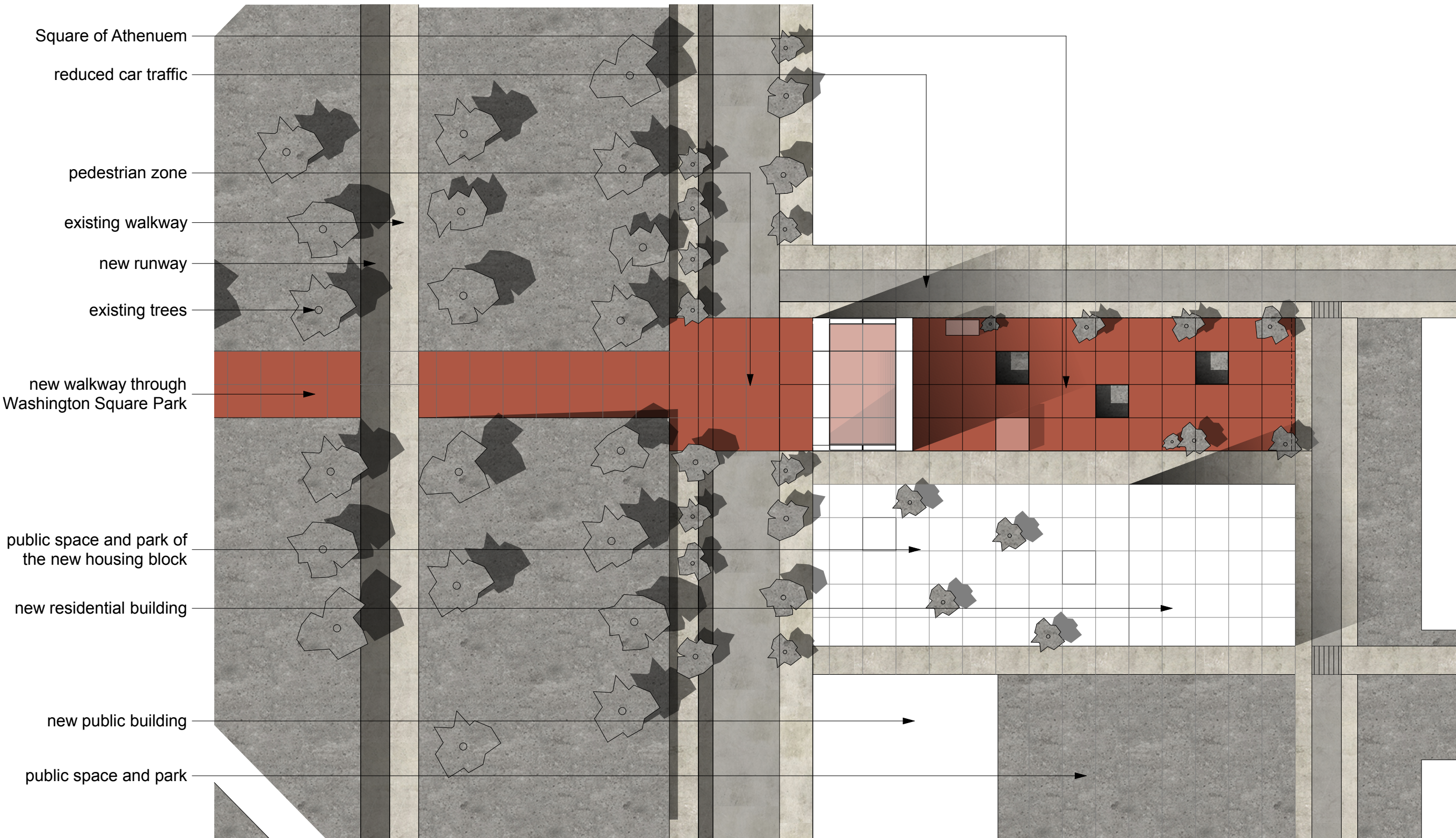

Volumes

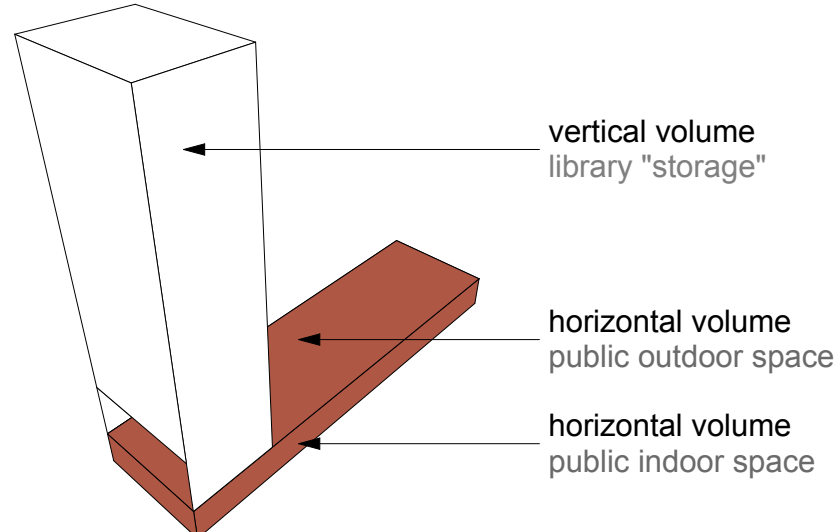

Access

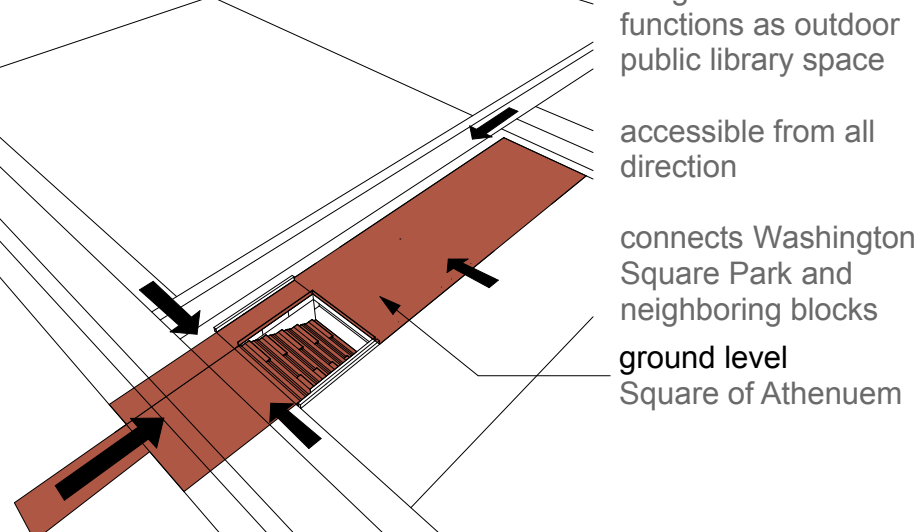

Functions

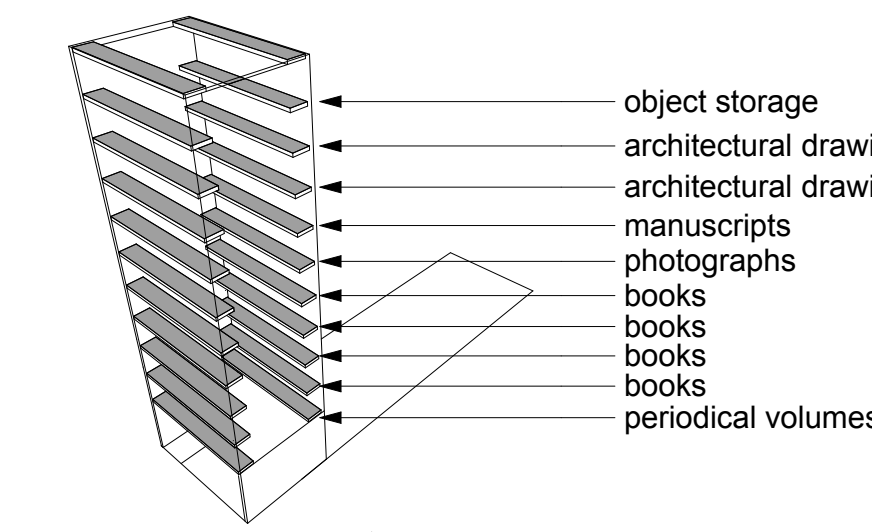

Movement

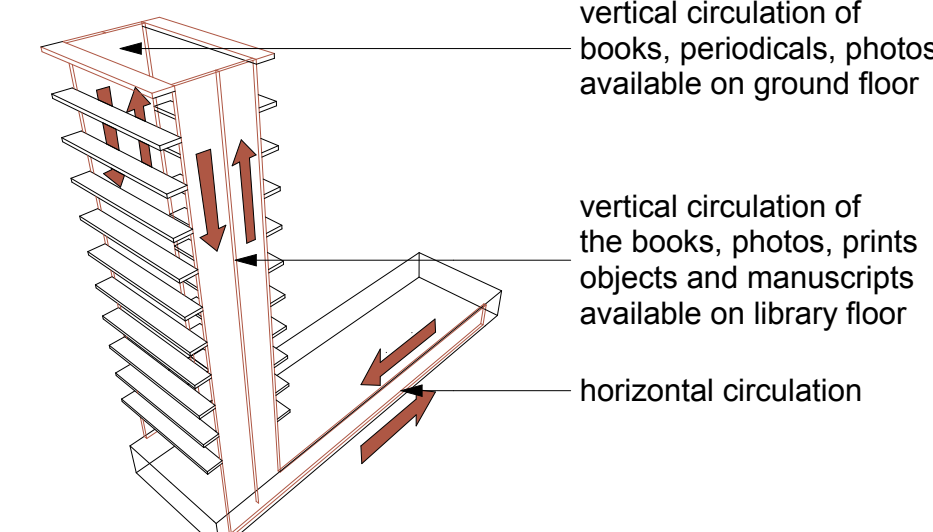

Sustainability

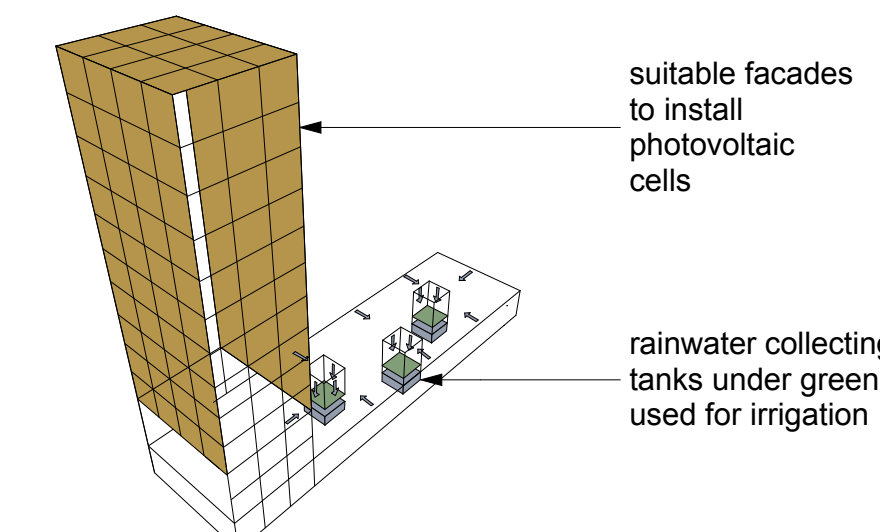

Books delivery system available on both floors

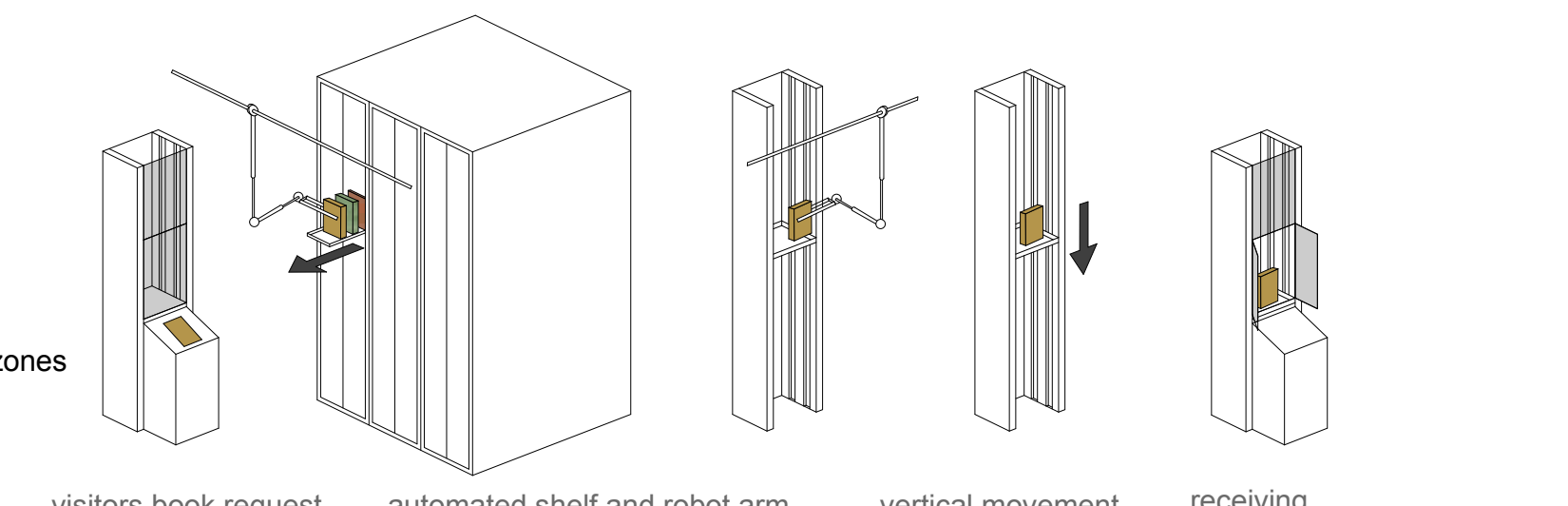

Grid

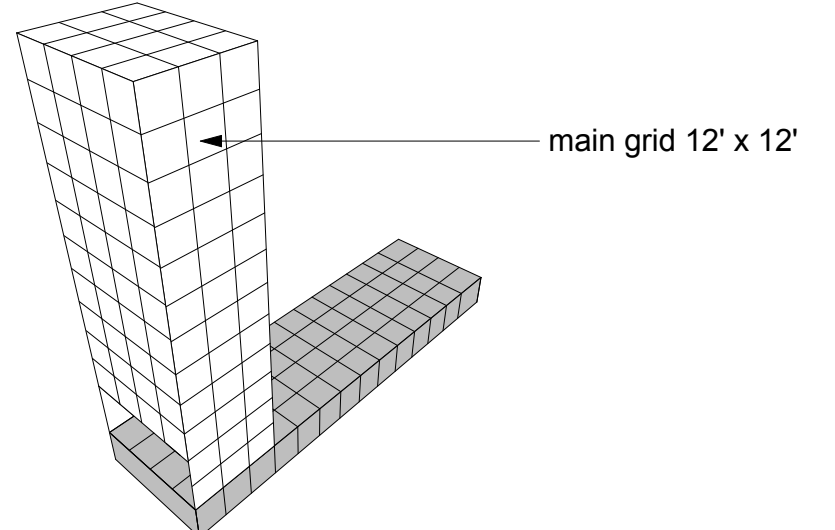

Evolution

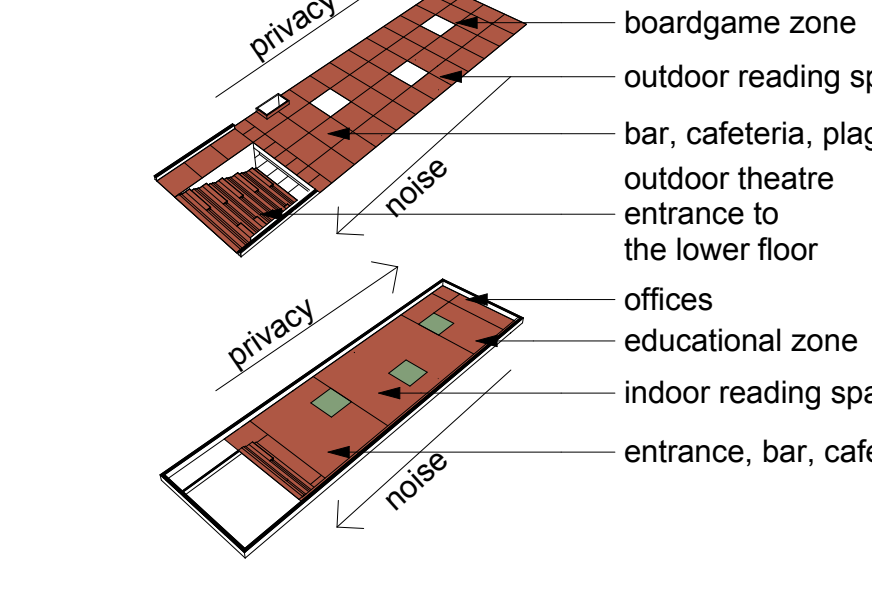
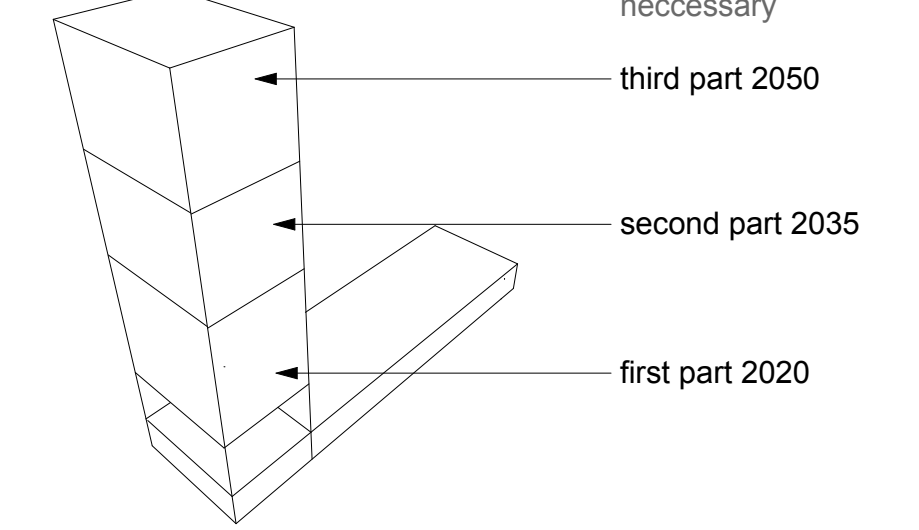

Structure

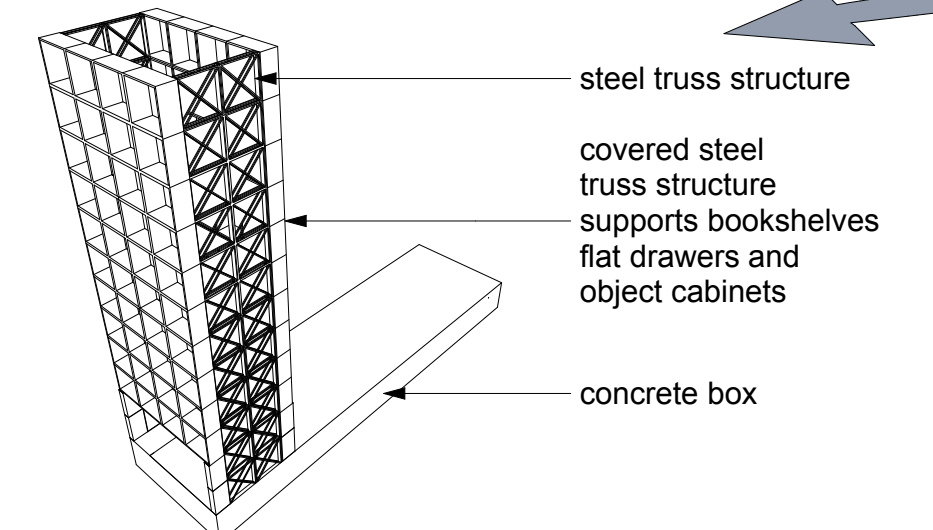

Heating and cooling system

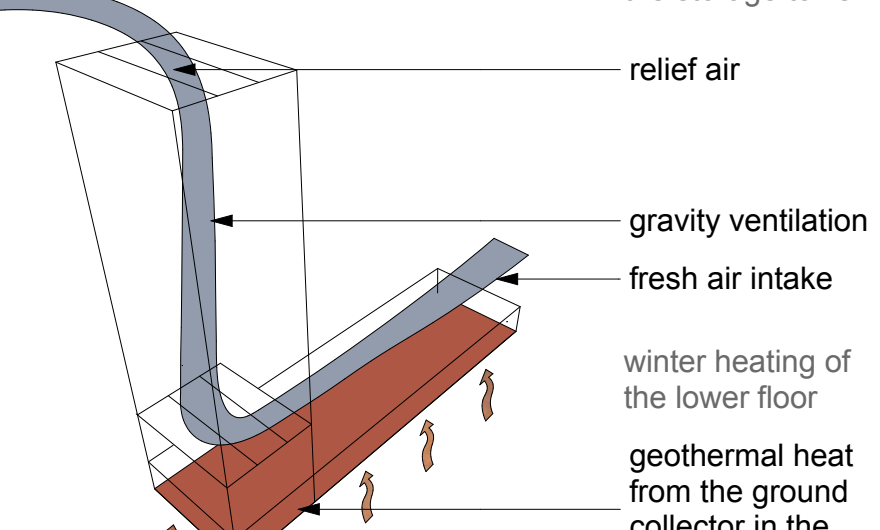

Drawing and photographs delivery system available on lower ground floor

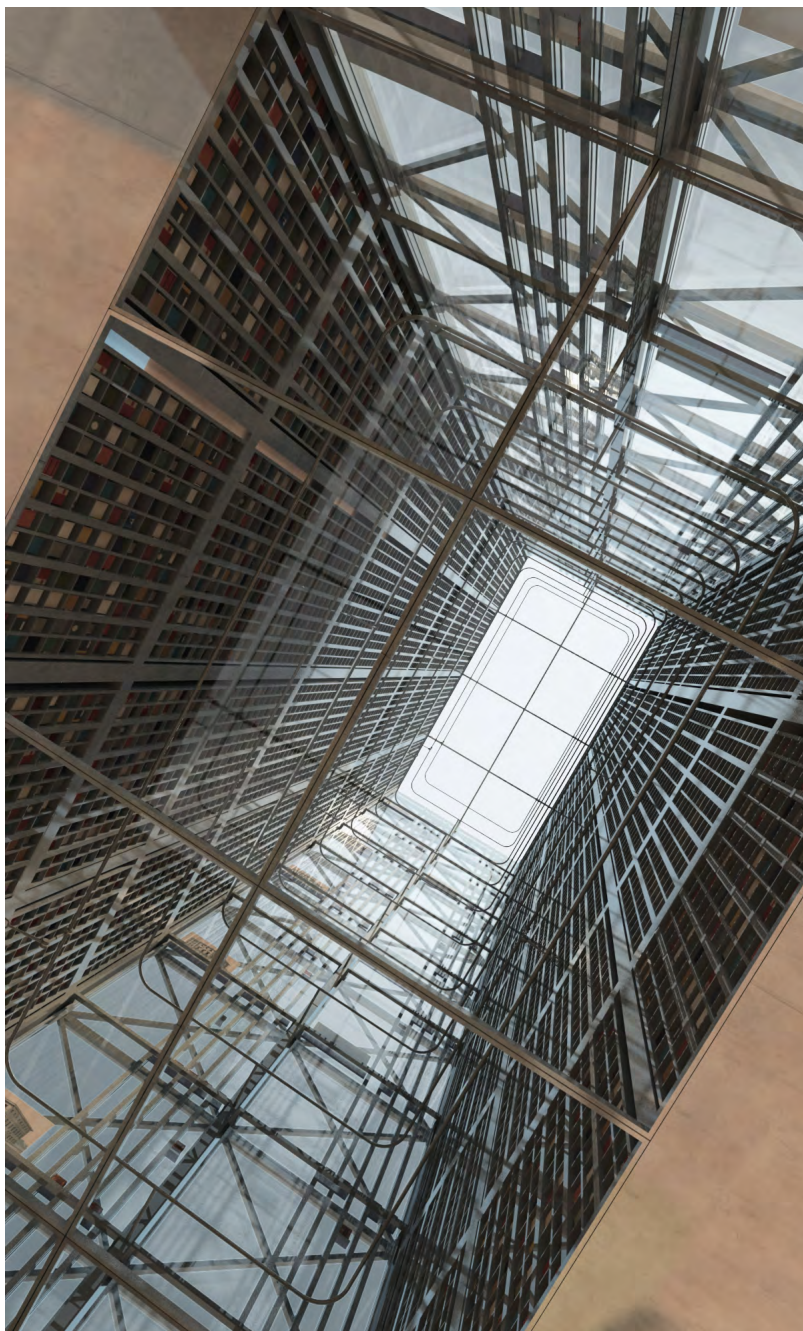
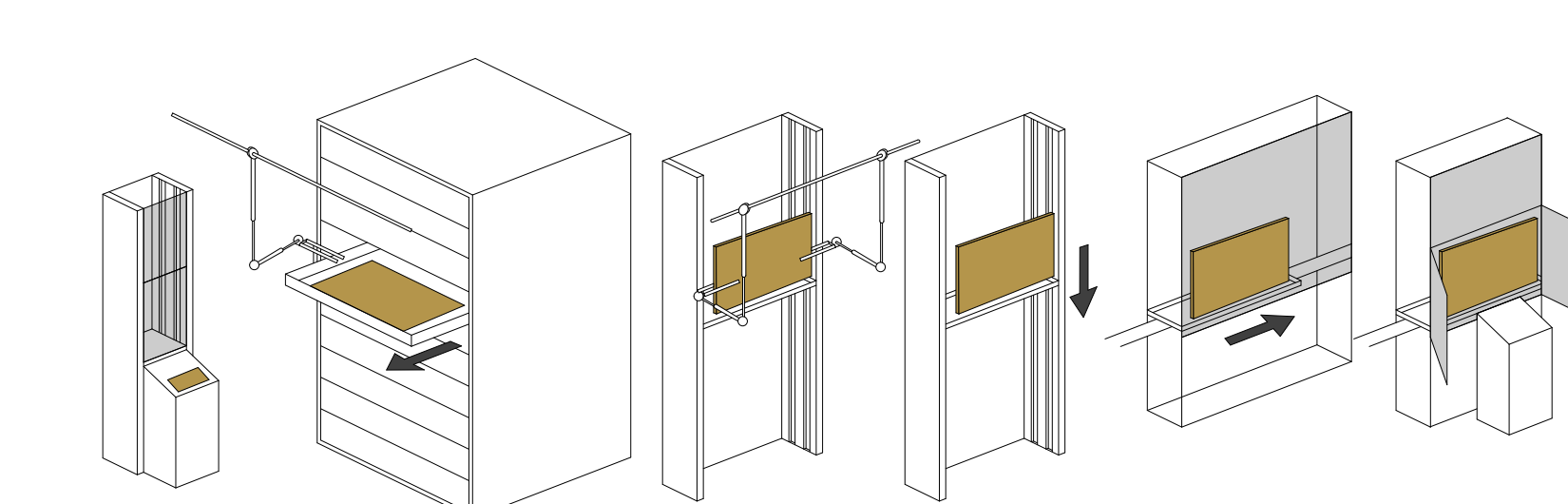

Lower ground plan

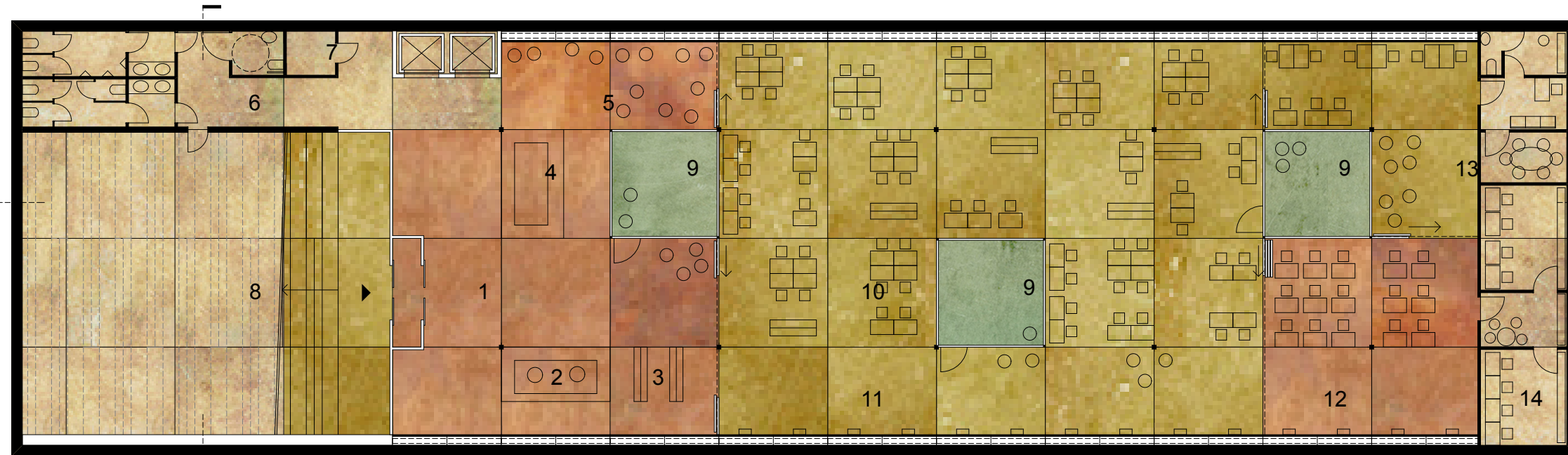

- 1 Lobby
 - 2 Reception
 - 3 Cloakroom
 - 4 Bar
 - 5 Cafeteria
 - 6 Restrooms
 - 7 Storage
 - 8 Technical zone, storage
 - 9 Atrium
 - 10 Reading zone
 - 11 Book request zone
 - 12 Education area
 - 13 Digital image zone
 - 14 Office area
- square footage: 8590 sq. ft

Ground floor plan

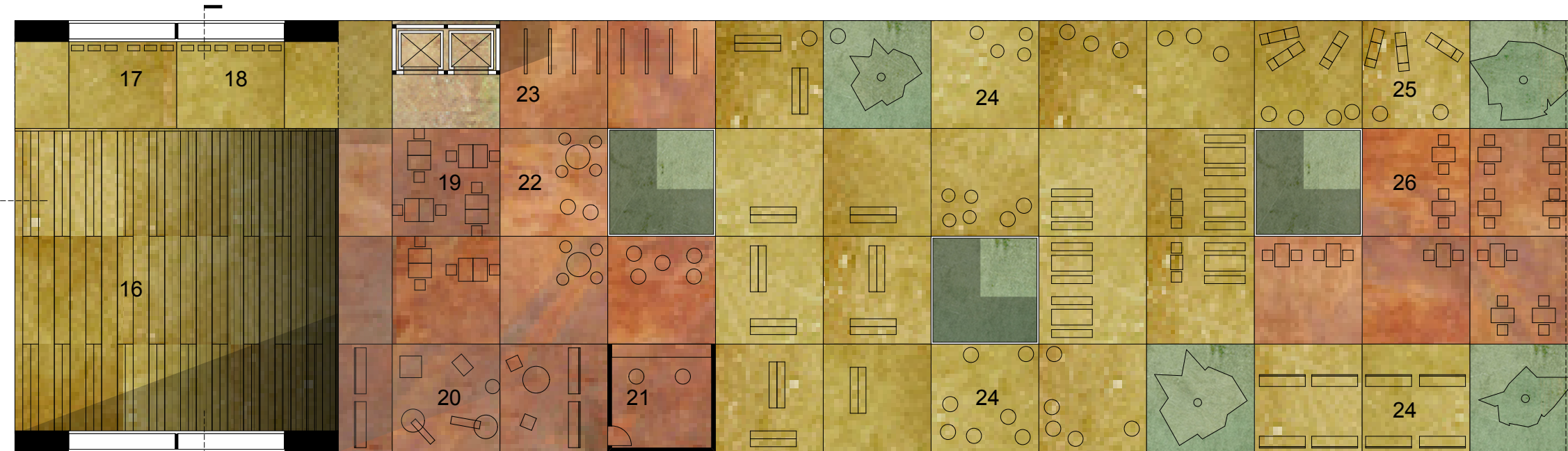

16. Theatre
 17. Book request
 18. Book return
 19. Chat zone
 20. Playground
 21. Bar
 22. Cafeteria
 23. Bicycle parking
 24. Reading zone
 25. Chillout zone
 26. Playzone
- square footage: 8590 sq. ft square footage: 8854 sq. ft
Total square footage: 26034 sq. ft

Pattern of the ground floor



First floor plan

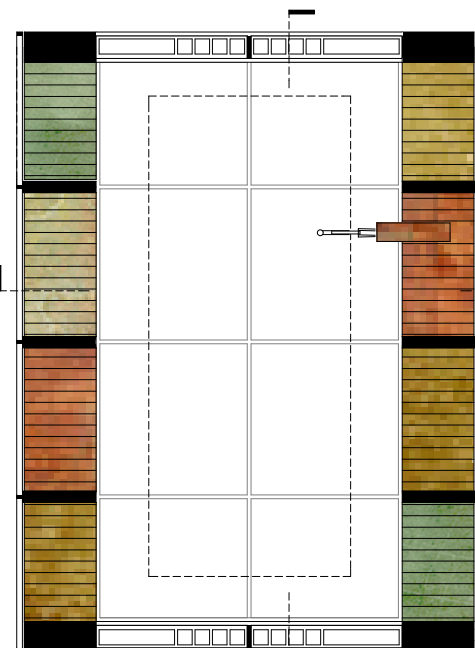

Periodical storage - 4850 lin feet

Second floor plan

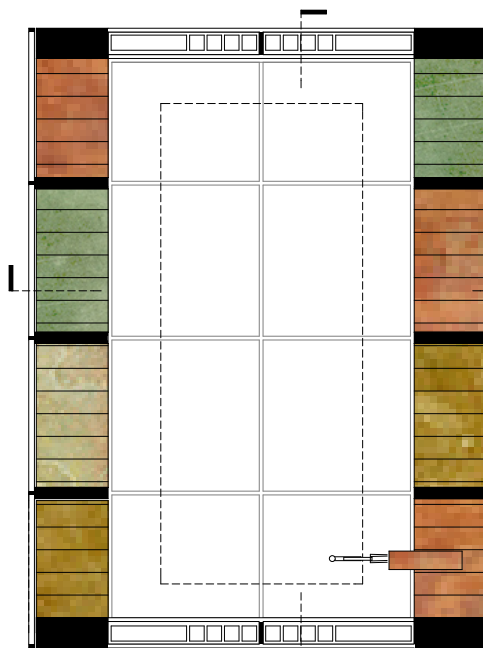

Book storage - shelves 4850 lin feet

Third floor plan

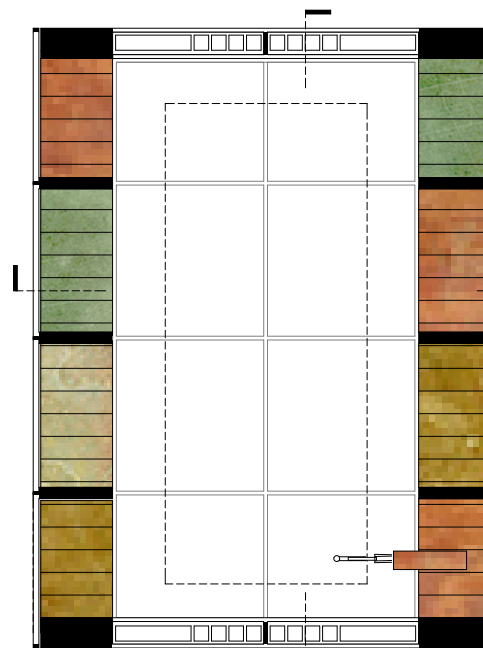

Book storage - shelves 4850 lin feet

Fourth floor plan

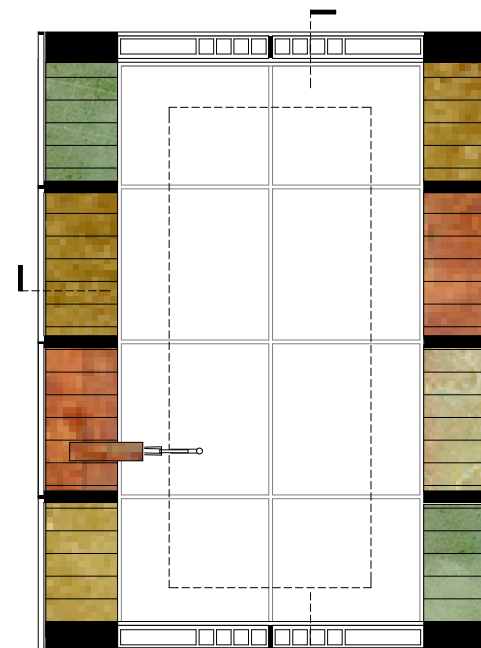

Book storage - shelves 4850 lin feet

Fifth floor plan

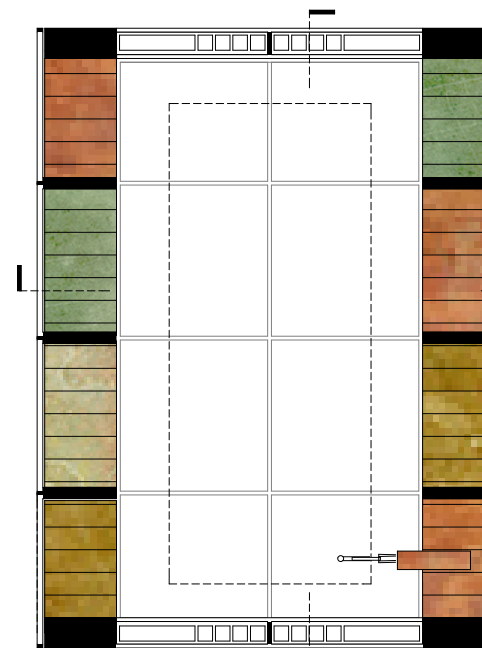

Book storage - shelves 4850 lin feet

Fifth floor plan

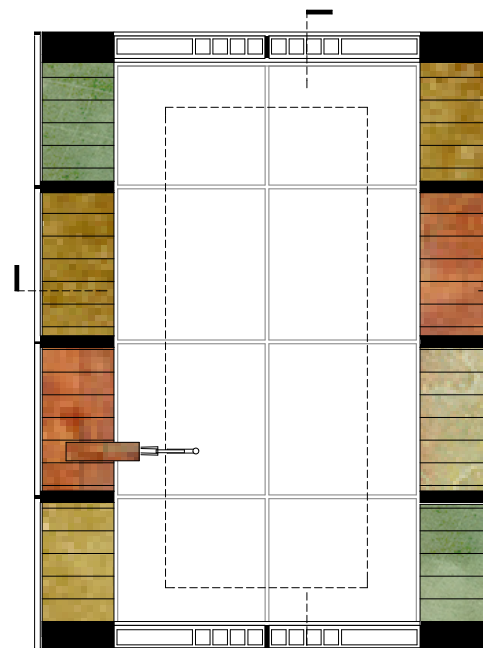

Photograph storage - shelves

Sixth floor plan

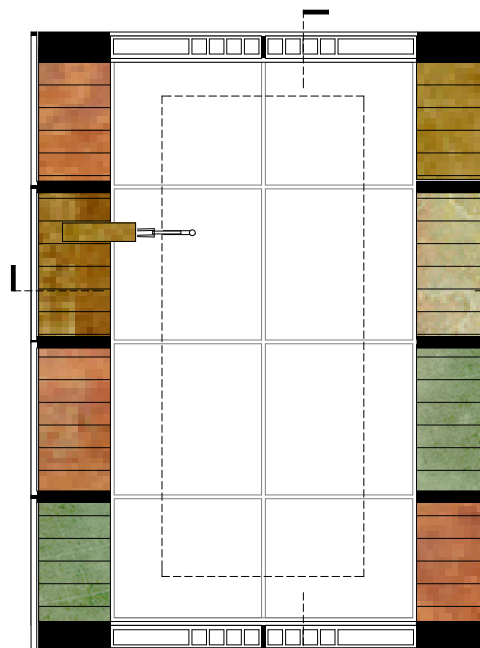

Manuscripts storage - shelves

Seventh floor plan

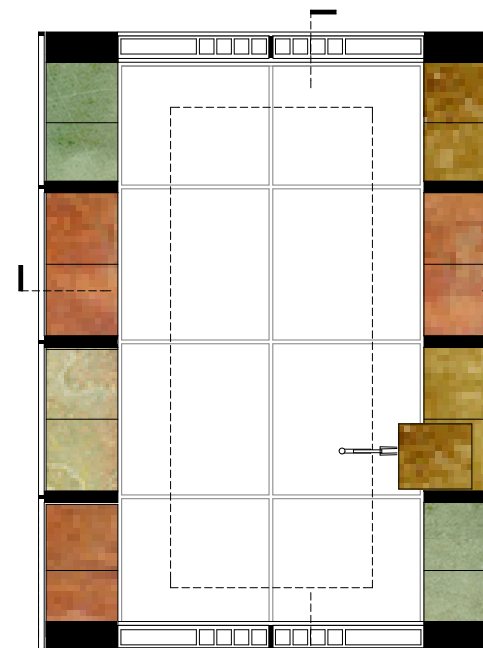

Architectural drawings/rolls - cabinets

Eighth floor plan

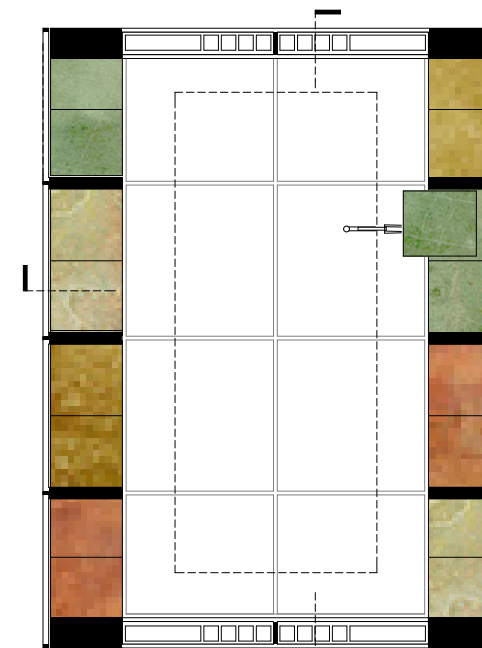

Architectural drawings/prints - drawers

Ninth floor plan

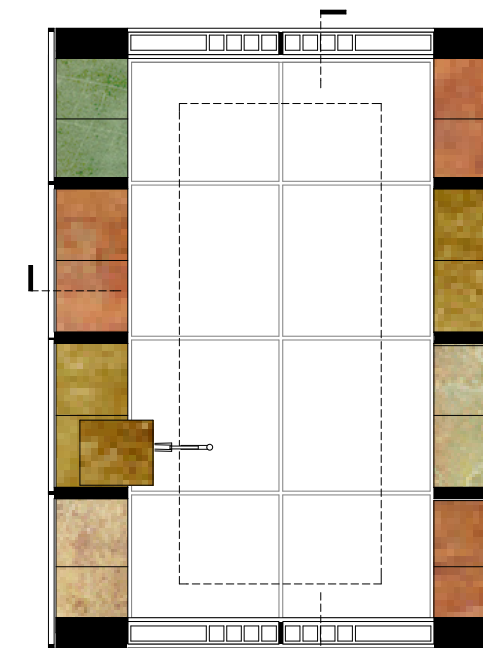

Architectural drawings/prints - drawers

Tenth floor plan

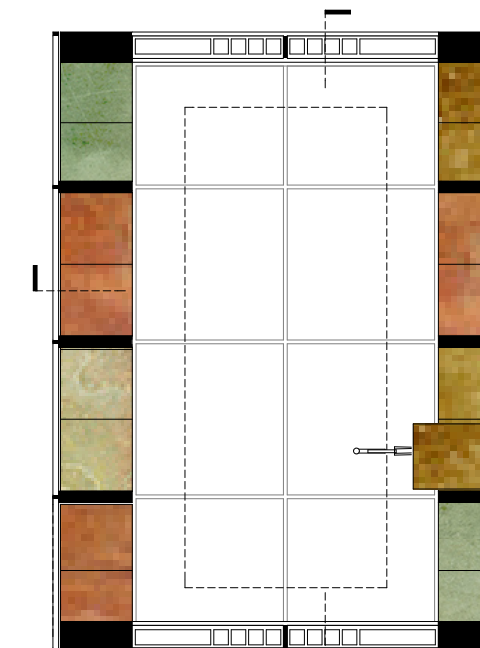

Object storage - cabinets

Pattern of the lower floor

