

ELEVATION DETAIL _ NÉZETRÉSZLET M= 1:200

ARCHITECTURAL CONCEPT _ VONALAS VÁZLAT

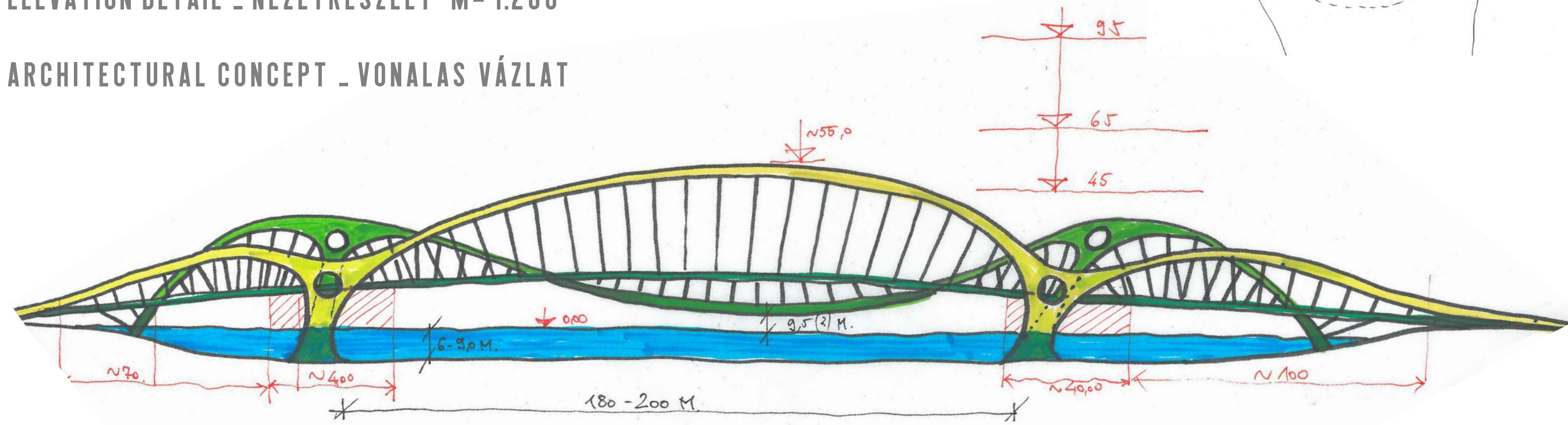

ARCHITECTURAL CONCEPT _ ÉPÍTÉSZETI KONCEPCIÓ

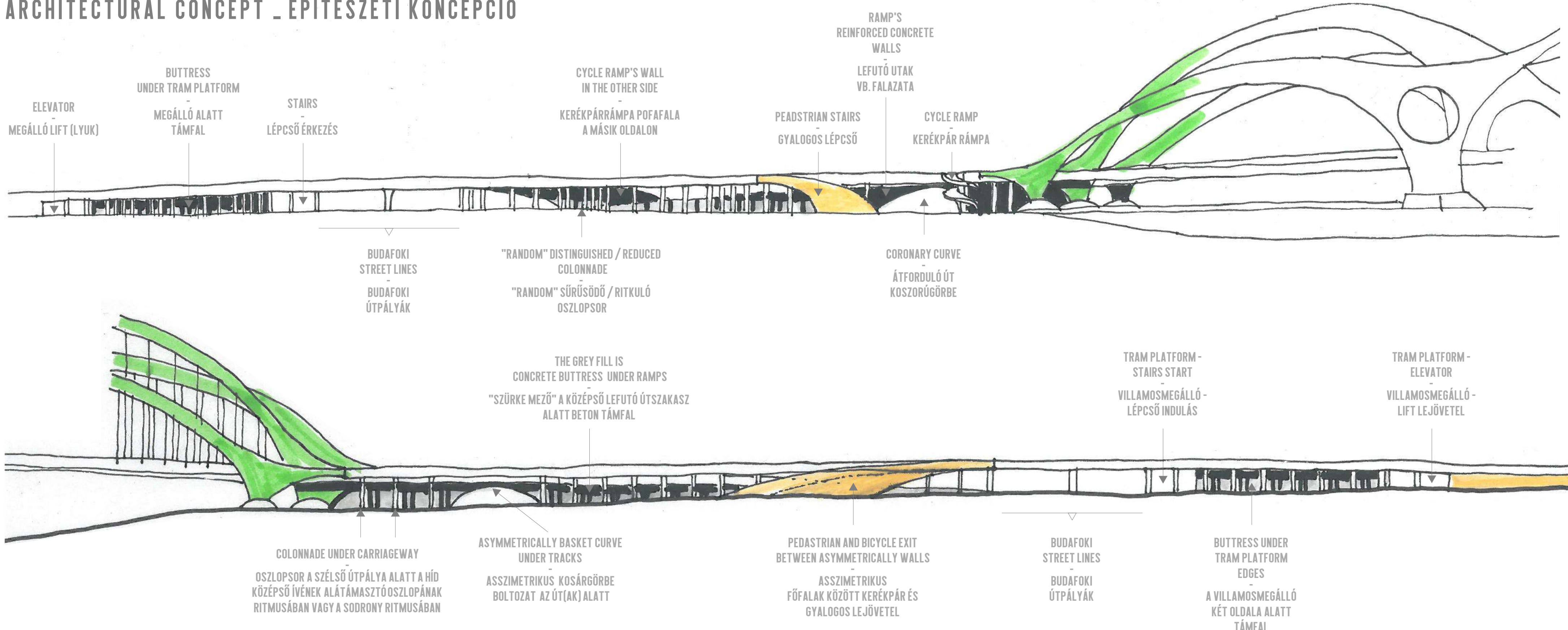

SKETCH _ VÁZLAT M= 1:100

FLOOR PLAN _ ALAPRAJZ M= 1:100

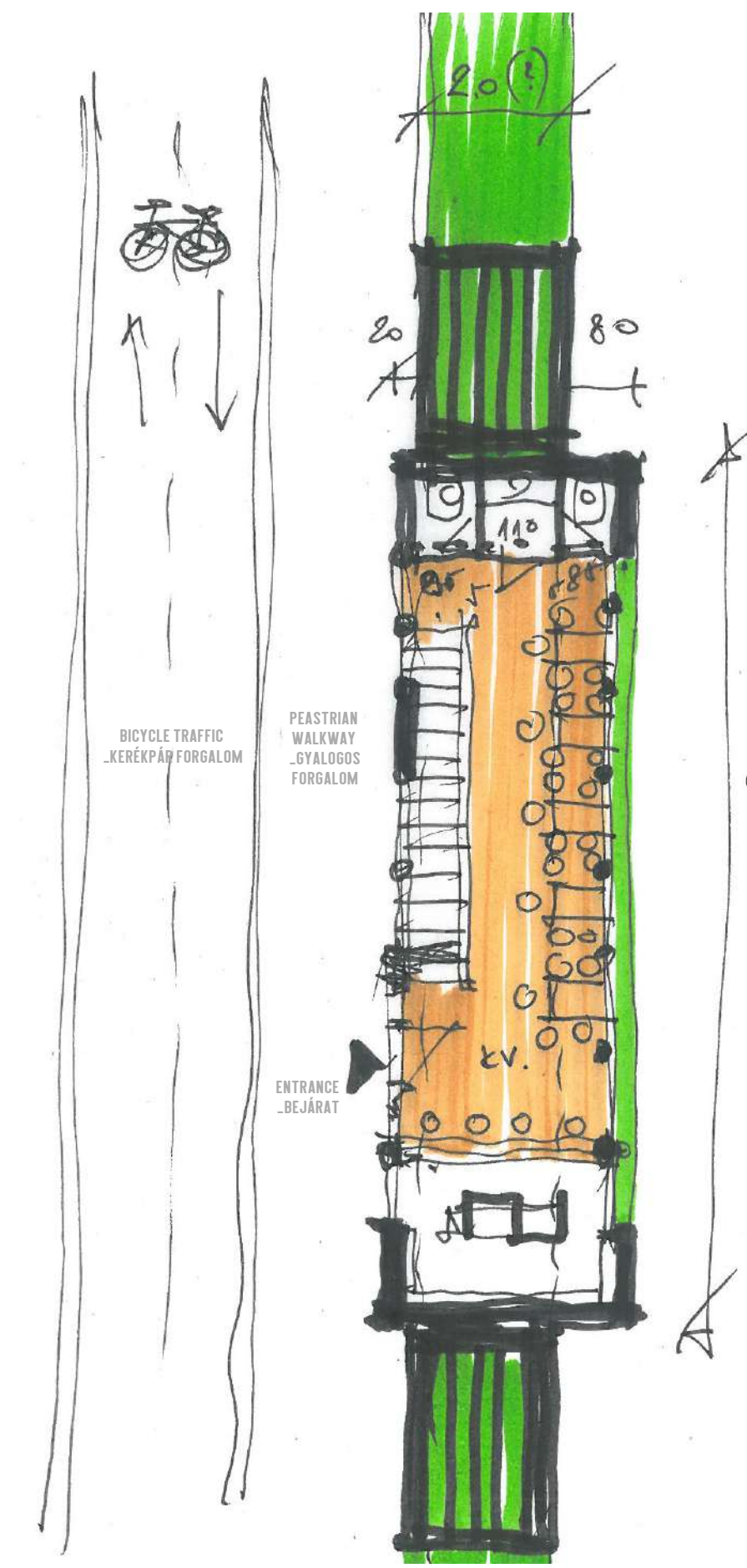

KÁVÉZÓ KILÁTÓ INFO POINT HÍDMESTER (?) RENDEZVÉNY (?)

CAFE VIEWPOINT INFO POINT BRIDGE MASTER (?) EVENT (?)

ELEVATION VARIATIONS FROM PYLON _ VÁZLATOK A PYLONRÓL

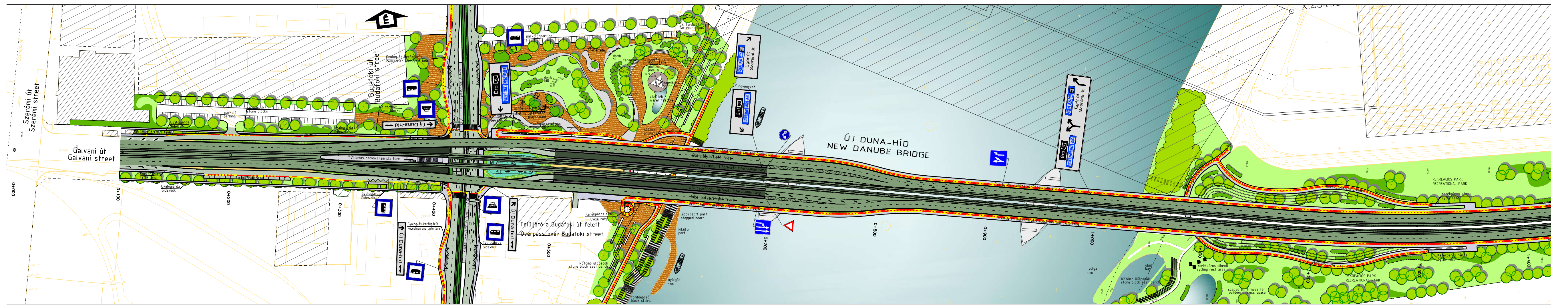
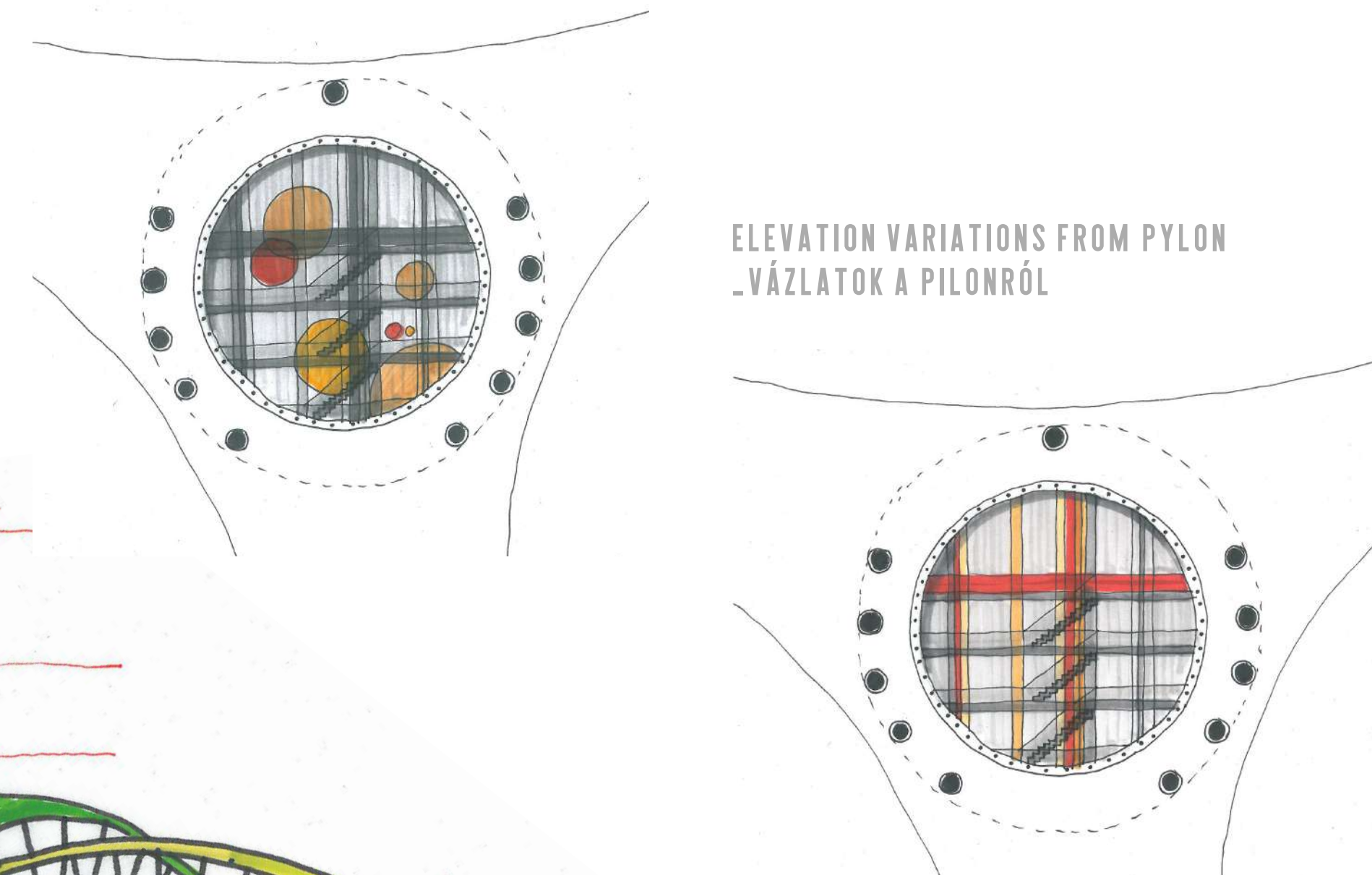

FLOOR PLAN _ ALAPRAJZ M= 1:200

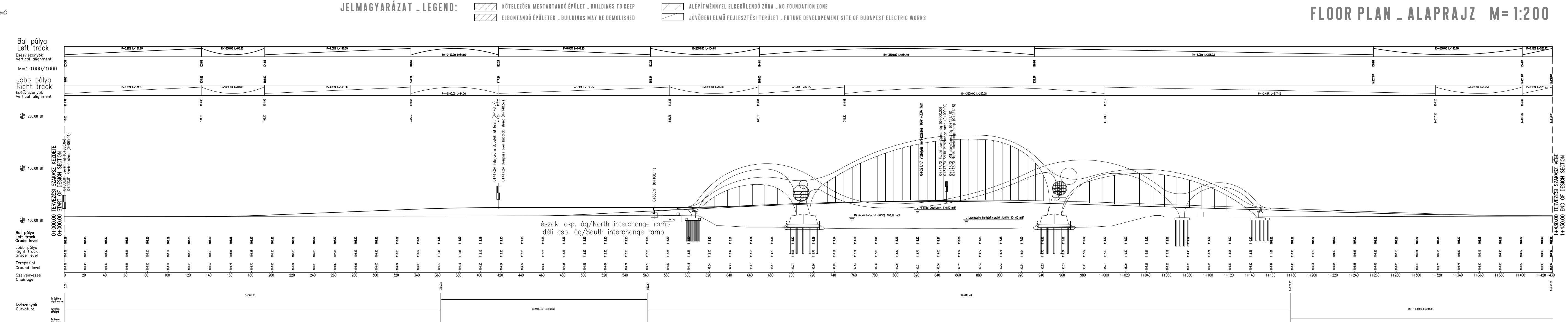

LONGITUDINAL SECTION _ HOSSZMETSZET M= 1:200

A HÍD TÉRBELI VÉGESELEMES MODELLEJE _ SPATIAL FINITE ELEMENT MODEL OF THE BRIDGE

FORGALMI TERHEK AZ E-07 07.01.12 SZERINT

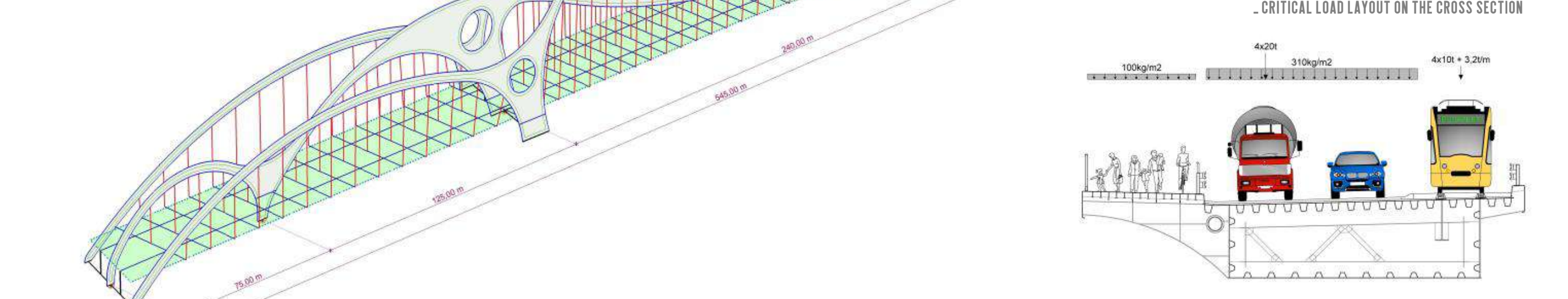
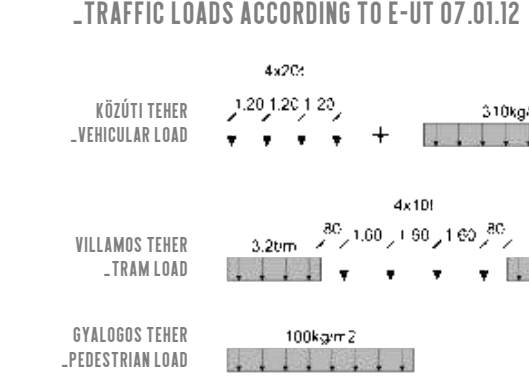

MÉRTÉKADÓ VON MISES FESZÜLTSEGEK AZ ÍVEKBEIN _ CRITICAL LOAD LAYOUT ON THE CROSS SECTION

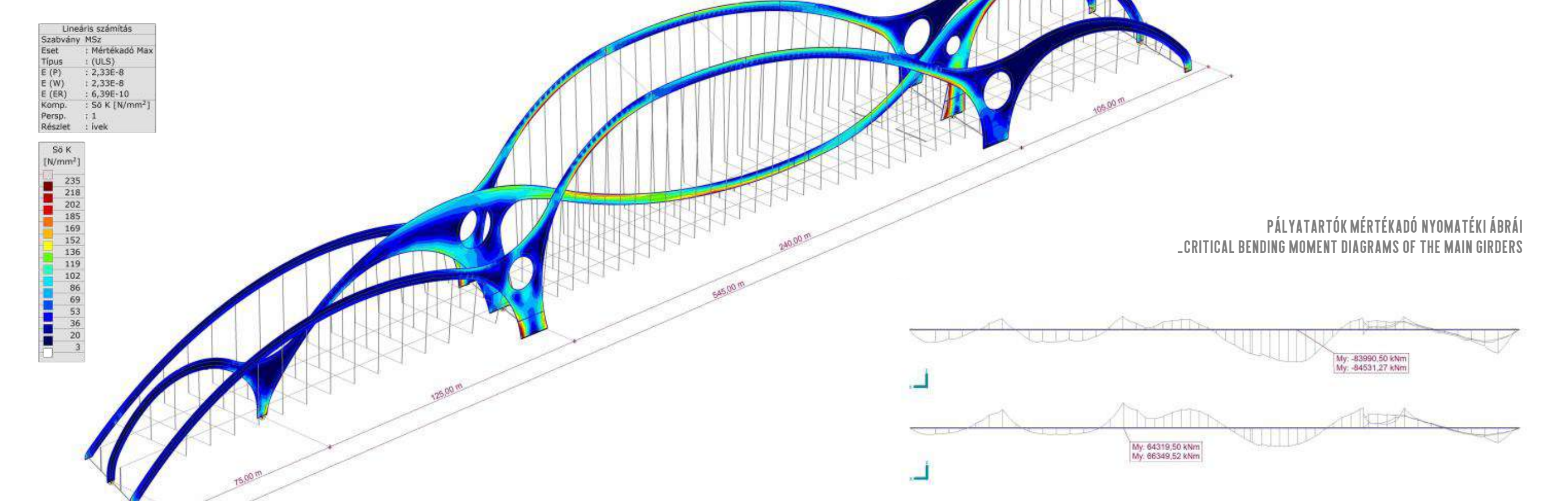

MÉRTÉKADÓ VON LEHJÁLÁS A FORGALMI TERHEKBŐL AZ E-07 07.01.12 SZERINT

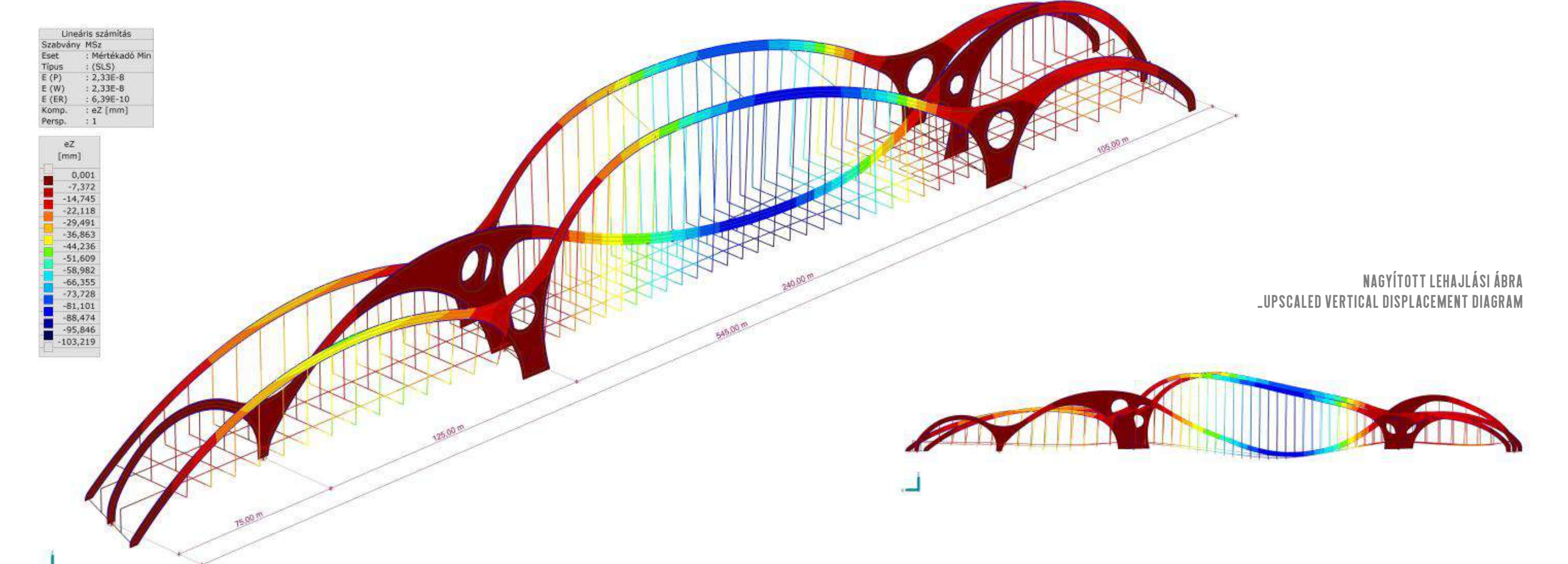

- BOTH TRACK REAR ON THE PYLONS. IN THE DIRECTION PERPENDICULAR TO THE WIRES, THE SPINDLE'S POSITION CAN CHANGE. IN THE ISLAND'S SIDE.
- LIKE THE FIRST, BUT THE TRACKS THEN SWEEP AND STRETCH OVER ABOVE THE WATERPILINGS.
- THE TWO SELECTED EMPLOYERS ARE PARALLEL TO THE PATHS. THE TWO Pylon LINES DON'T RESEMBLE TO THE TRACKS.
- THE TRACKS TURN TO THE OPPOSITE PYLONS IN THE DOWNRAISES. THE TWO PATHS CAN WAVE UNSTABLELY.
- BRIDGE'S ENVIRONMENT WITH DAYS, RESTING CHAIRS, KÉNYELTETÉSEK, KÖLÉRTÉSA NYILVÁRTÁRAKAL

- THE TRACKS TURN TO THE OPPOSITE PYLONS IN THE DOWNRAISES. THE TWO PATHS CAN WAVE UNSTABLELY.
- BRIDGE'S ENVIRONMENT WITH DAYS, RESTING CHAIRS, KÉNYELTETÉSEK, KÖLÉRTÉSA NYILVÁRTÁRAKAL

- BRIDGE'S ENVIRONMENT WITH DAYS, RESTING CHAIRS, KÉNYELTETÉSEK, KÖLÉRTÉSA NYILVÁRTÁRAKAL